

Crown Later PTH Hydraulic Unit

Serial #3-183850 and higher

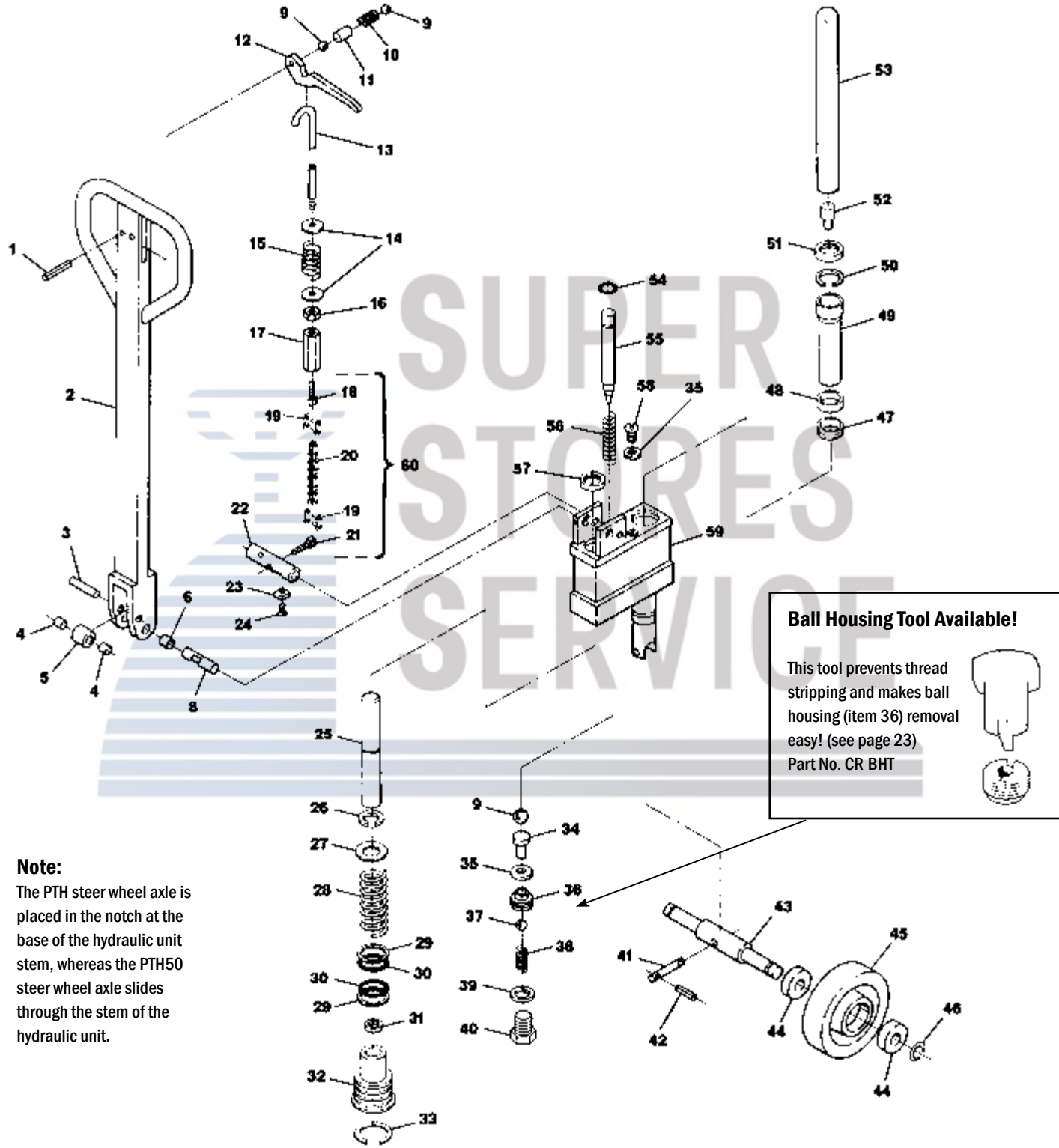

Ball Housing Tool Available!
This tool prevents thread stripping and makes ball housing (item 36) removal easy! (see page 23)
Part No. CR BHT

Note:
The PTH steer wheel axle is placed in the notch at the base of the hydraulic unit stem, whereas the PTH50 steer wheel axle slides through the stem of the hydraulic unit.

Crown Later PTH Hydraulic Unit

Serial #3-183850 and higher

Item	Part No.	Description
1	50000-012	Roll Pin
2	41293	Handle Assembly, (Includes Items 1-6 and 9-17)
3	41191	Roller Axle
4	55017-002	Roller Bearing
5	41192	Roller
6	41194	Bushing
8	41252	Handle Axle
9	A B 55001-007	Ball
10	41292	Spring
11	41326	Sleeve
12	41325	Control Lever
13	41295	Control Rod
14	41193	Washer
15	79918	Spring
16	50008-008	Nut
17	41190	Adjusting Nut
18	41180	Chain Connector
19	79905	Master Link
20	79904	Chain
21	41272	Chain Connector
22	41302	Pin
23	A 41303	Actuating Plate
24	A 50003-012	Screw
25	A 41996	Piston
	41999	Piston and Cylinder Assembly (Includes Items 25, 29-32)
26	A 50012-021	Snap Ring
27	41170	Washer
28	79908	Spring
29	A B 64074-005	Back-Up Ring
30	A B 54002-012	O-Ring
31	A B 54015-004	U-Cup
32	41995	Pump Cylinder
33	A 50012-026	Snap Ring
34	A B 41286	Tappet
35	A B 50011-010	Washer
36	A B 41289	Ball Housing
37	A B 55001-002	Ball
38	A B 41288	Spring
39	A B 50011-020	Washer
40	A 41301	Screw Plug
41	41195	Pin
42	50000-001	Roll Pin

Item	Part No.	Description
43	41270	Steer Wheel Axle
44	65081-020	Bearing
45	41275-1-HD	Steer Wheel Assembly, Red Ultra-Poly On Aluminum Hub W/Bearings
	41275-1-ST	Steer Wheel Assembly, Black Poly On Nylon Hub W/ Bearings
	41275-2	Steer Wheel Assembly, Nylon W/ Bearings
	41275-3	Steer Wheel Assembly, Steel W/ Bearings
	GWK-PTH-CK	Complete Wheel Kit, (2) Ultra-Poly Load Roller Assemblies (70D), (2) Poly Steer Wheel Assemblies, W/ Bearings, Axles & Fasteners
46	50012-021	Snap Ring
47	A B 41166	Bushing
48	A B 54015-001	U-Cup
49	41165	Bushing
50	A 50012-025	Snap Ring
51	A B 54001-008	Scraper
52	41254	Magnet and Sleeve Assembly
53	41163	Ram Assembly (Includes Item 52)
54	A B 54002-011	O-Ring
55	41284	Release Pin
56	A B 79915	Spring
57	A B 54001-002	Scraper
58	A 41181	Filler Plug
59	HU CR PTH-1PC	Rebuilt Hydraulic Unit - Exchange
60	79904-A	Chain Assembly (Includes Items 18 - 21)
61	41295-A	Pull Rod Chain Assembly (Includes Items 13-21)
KITS A	43023-SUPER	Super Seal Kit
KITS B	43023	Seal Kit

Complete Wheel Kit

