

Crown Older PTH Hydraulic Unit

Serial #3-118400 to #3-183849

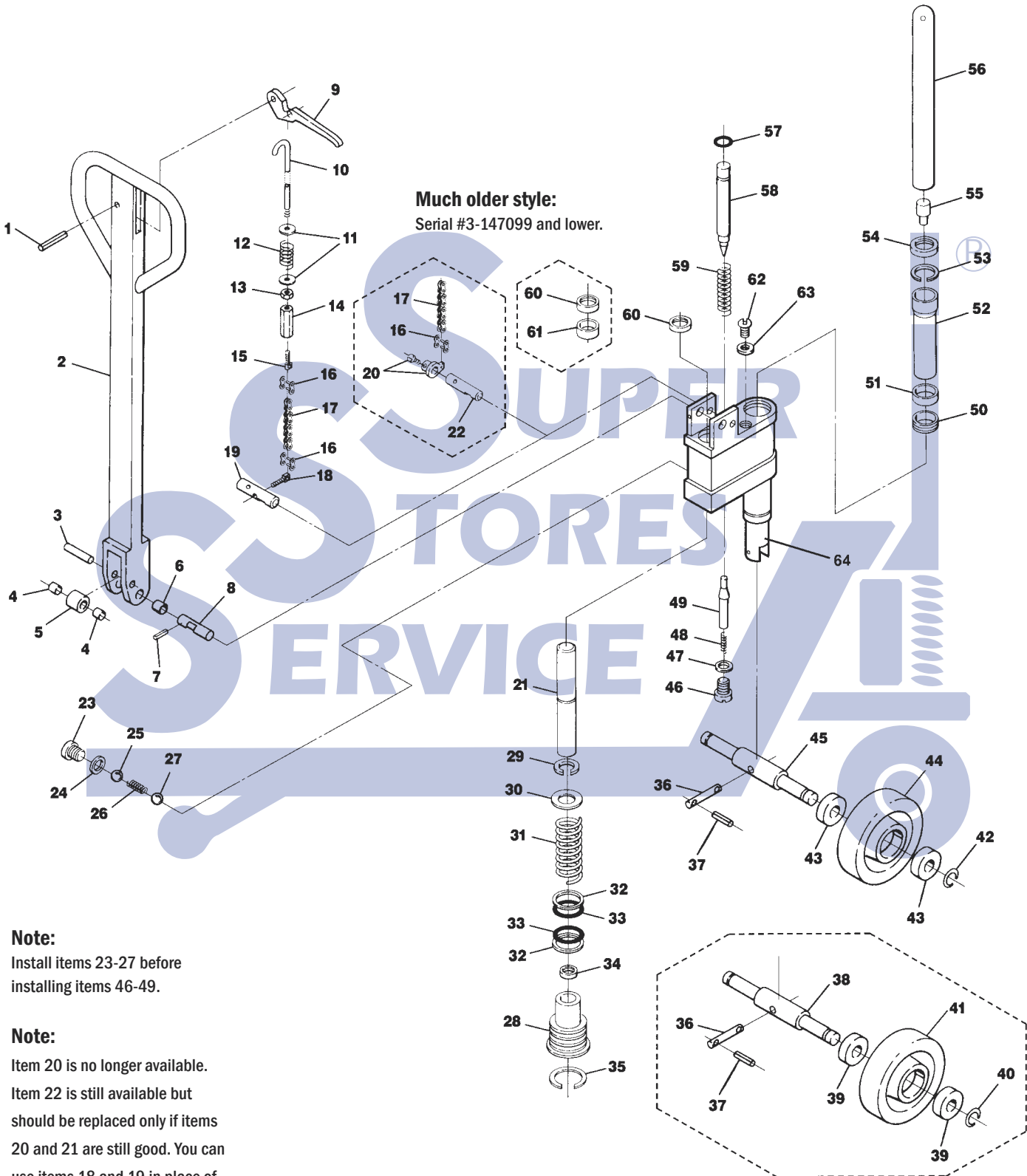

Note:
Install items 23-27 before installing items 46-49.

Note:
Item 20 is no longer available.
Item 22 is still available but should be replaced only if items 20 and 21 are still good. You can use items 18 and 19 in place of items 20 and 22 without needing to replace additional parts.

Much older style:
25mm bearing ID,
serial #3-147099 and lower.

Crown Older PTH Hydraulic Unit

Serial #3-118400 to #3-183849

| Item | Part No. | Description | List Price |
|------|---------------|--|---------------|
| 1 | 50000-012 | Roll Pin | \$0.50 |
| 2 | 41182 | Handle Assy, (Incl. Items 1-6 and 9-14) | \$99.00 |
| 3 | 41191 | Roller Axle | \$5.00 |
| 4 | 55017-002 | Roller Bearing | \$10.00 |
| 5 | 41192 | Roller | \$8.00 |
| 6 | 41194 | Bushing | \$3.00 |
| 7 | 50000-015 | Roll Pin | \$0.50 |
| 8 | 41252 | Handle Axle | \$12.00 |
| 9 | 79873 | Control Lever | \$15.00 |
| 10 | 41189 | Control Rod | \$10.00 |
| 11 | 41193 | Washer | \$0.50 |
| 12 | 79918 | Spring | \$1.00 |
| 13 | 50008-008 | Nut | \$0.50 |
| 14 | 41190 | Adjusting Nut | \$5.00 |
| 15 | 41180 | Chain Connector | \$3.00 |
| 16 | 79905 | Master Link | \$2.50 |
| 17 | 79904 | Chain | \$3.00 |
| 18 | 41272 | Chain Connector | \$5.00 |
| 19 | 41271 | Pin | \$10.00 |
| 20 | - | Replace W/ Items 18 & 19 | Not Available |
| 21 | A 41996 | Piston | \$20.00 |
| | 41999 | Piston and Cylinder Assembly (Includes Items 25,29,30,31,32) | \$90.00 |
| 22 | 41176 | Pin | \$5.00 |
| 23 | A 41171 | Screw Plug | \$4.00 |
| 24 | A B 50011-018 | Washer | \$1.00 |
| 25 | A B 65002-005 | Ball | \$2.00 |
| 26 | A B 79914 | Spring | \$1.00 |
| 27 | A B 65002-007 | Ball | \$2.00 |
| 28 | 41995 | Pump Cylinder | \$49.00 |
| 29 | A 50012-021 | Snap Ring | \$0.50 |
| 30 | 41170 | Washer | \$3.00 |
| 31 | 79908 | Spring | \$8.00 |
| 32 | A B 64074-005 | Back-Up Ring | \$1.00 |
| 33 | A B 54002-012 | O-Ring | \$4.00 |
| 34 | A B 54015-004 | U-Cup | \$5.00 |
| 35 | A 50012-026 | Snap Ring | \$2.00 |
| 36 | 41195 | Pin | \$7.00 |
| 37 | 50000-001 | Roll Pin | \$0.50 |
| 38 | 41197 | Steer Wheel Axle | \$30.00 |
| 39 | 65081-021 | Bearing | \$5.00 |
| 40 | 50012-022 | Snap Ring | \$0.50 |
| 41 | 82274-1-HD | Steer Wheel Assembly, Red Ultra Poly On Aluminum Hub W/ Bearings, 25 mm Bearing ID | \$55.00 |

| Item | Part No. | Description | List Price |
|------|---------------|---|------------|
| 41 | 82274-1-ST | Steer Wheel Assembly, Black Poly On Nylon Hub W/ Bearings, 25 mm Bearing ID | \$38.00 |
| | 82274-2 | Steer Wheel Assembly, Nylon W/ Bearings, 25 mm Bearing ID | \$36.00 |
| | 82274-3 | Steer Wheel Assembly, Steel W/ Bearings, 25 mm Bearing ID | \$59.00 |
| 42 | 50012-021 | Snap Ring | \$0.50 |
| 43 | 65081-020 | Bearing | \$5.00 |
| 44 | 41275-1-HD | Steer Wheel Assembly, Red Ultra Poly On Aluminum Hub W/ Bearings, 20 mm Bearing ID | \$55.00 |
| | 41275-1-ST | Steer Wheel Assly, Black Poly On Nylon Hub W/ Bearings, 20 mm Bearing ID | \$38.00 |
| | 41275-2 | Steer Wheel Assembly, Nylon W/Bearings, 20 mm Bearing ID | \$36.00 |
| | 41275-3 | Steer Wheel Assembly, Steel W/ Bearings, 20 mm Bearing ID | \$59.00 |
| | GWK-PTH-CK | Complete Wheel Kit, (2) Load Roller Assy, (2) Steer Wheel Assembly W/ Bearings, Axles and Fasteners | \$124.95 |
| 45 | 41270 | Steer Wheel Axle | \$14.00 |
| 46 | A 41172 | Screw Plug | \$5.00 |
| 47 | A B 50011-015 | Washer | \$1.00 |
| 48 | A B 79913 | Spring | \$1.00 |
| 49 | A B 41174 | Valve | \$10.00 |
| 50 | A B 41166 | Bushing | \$4.00 |
| 51 | A B 54015-001 | U-Cup | \$7.00 |
| 52 | 41165 | Bushing | \$20.00 |
| 53 | A 50012-025 | Snap Ring | \$1.00 |
| 54 | A B 54001-008 | Scraper | \$5.00 |
| 55 | 41254 | Magnet and Sleeve Assembly | \$12.00 |
| 56 | 41163 | Ram Assembly (Incl Item 55) | \$49.00 |
| 57 | A B 54002-011 | O-Ring | \$2.00 |
| 58 | 41175 | Release Pin | \$28.00 |
| 59 | A B 79915 | Spring | \$1.00 |
| 60 | A B 54001-002 | Scraper | \$3.00 |
| 61 | 41162 | Bushing | \$12.00 |
| 62 | A 41181 | Filler Plug | \$2.00 |
| 63 | A B 50011-011 | Washer | \$0.50 |
| 64 | HU CR PTH-2PC | Rebuilt Hydraulic Unit - Exchange (Serial # 3-118400 to #3-183849) | *\$139.00 |
| KITS | A 41246-SUPER | Super Seal Kit | \$49.00 |
| KITS | B 41246 | Seal Kit | \$29.00 |

*Non-discounting item

Prices subject to change without notice. All manufacturers' names, part numbers and descriptions are used for reference purposes only. We do not imply that any parts are the products of a particular manufacturer. Copyright © 2008 by GPS, Inc. All rights reserved.