

Hydraulic Unit Identification

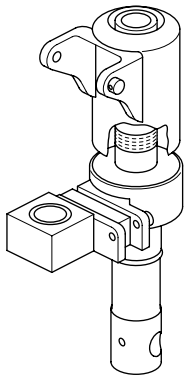

Atlas Zenith



Bishamon
BS-55

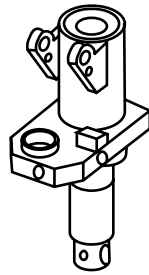

Blue Giant
MT-50

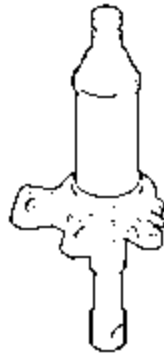

Blue Giant
PT-50/55



Blue Giant
ROI-5, ROI-55



BT
L 2000/L 2300

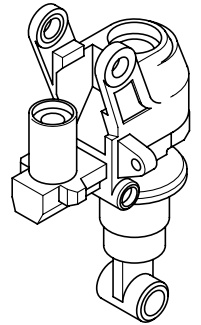

BT LHM 230

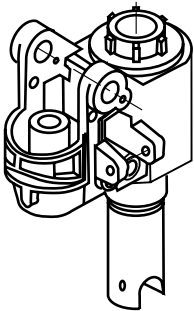

Clark

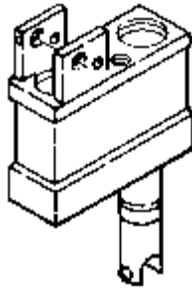

Crown
Later PTH

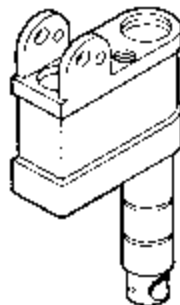

Crown
PTH50

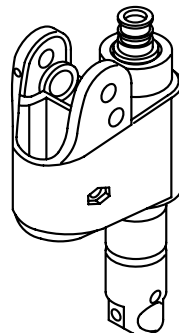

Crown
Newer PTH 50

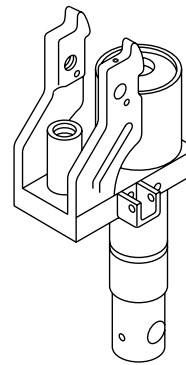

Dayton 3KR84

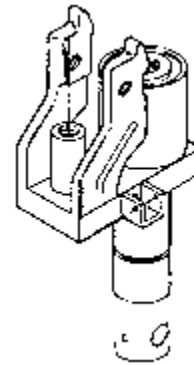

Eagleman



Global



Hu-Lift HP25L

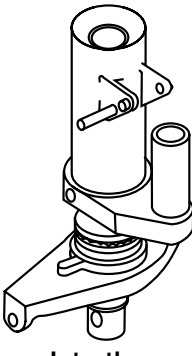

Interthor
K77/K85

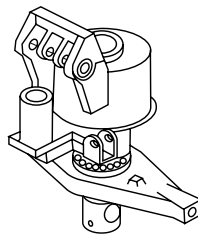

Jet A, L and J

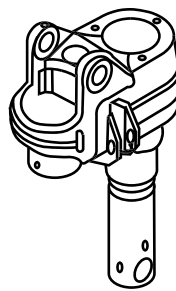

Jet W

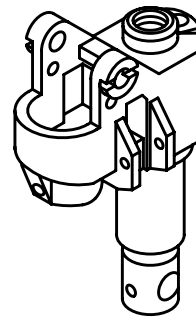

Jet PTX/JTX

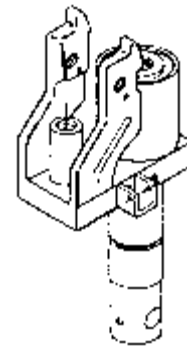

Lift-Rite L-50

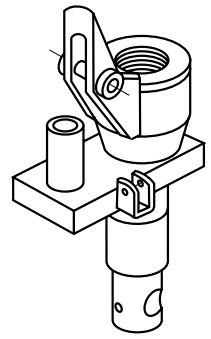

Lift-Rite L-55

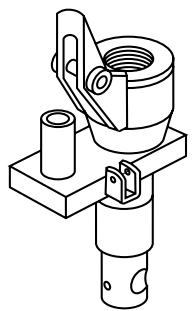

Lift-Rite
LRP 5000

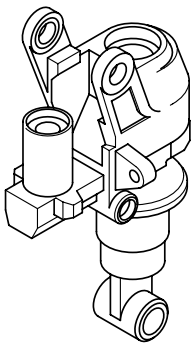

Lift-Rite
Titan Series

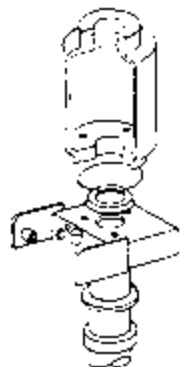

Magnum 5000

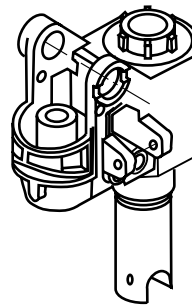

Mighty Lift
ML55

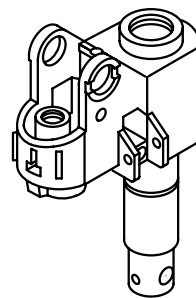

Mighty Lift
ML55L

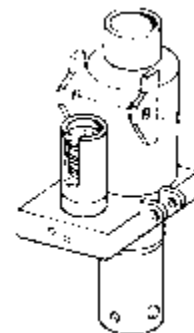

Mobile ML55

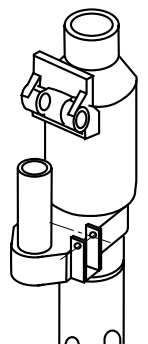

Mobile MLX55

Hydraulic Unit Identification

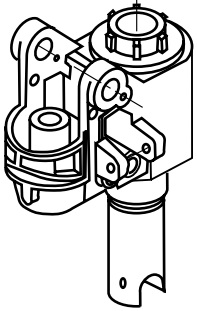

**Mobile
ECO I-55**



**Multiton
Hand Control**



**Multiton S
Foot Control**

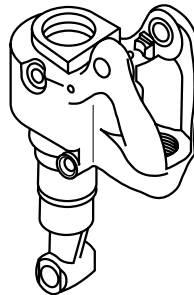

**Multiton
TM 55**



Palletmaster



**Pallet Mule
AA5000/AA5500**

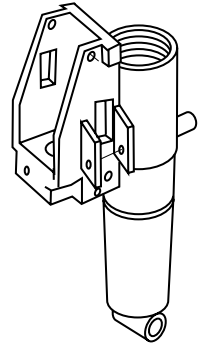

Pramac GS22



**Rol-Lift
Series T and E**

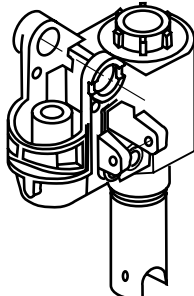

**Uline H-1043, H-1193,
H-1366, H-1484**

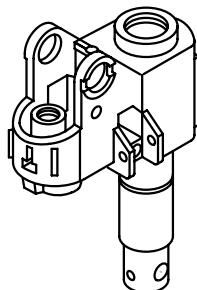

**Uline H-2708,
H-2900, H-3045**

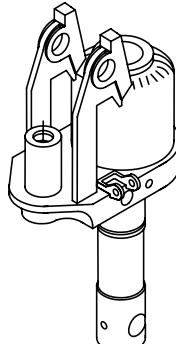

**Valu-Jack
5500**

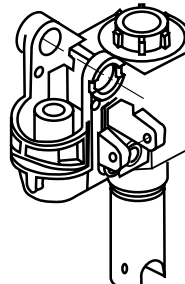

**Valu-Jack
5500-2**

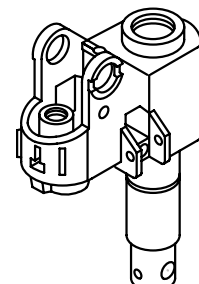

Wesco CP1